

How to update EVlink Pro AC through eSetup with local HTTP Server

MoP

Technical Support eMobility

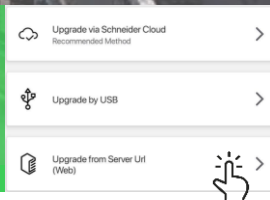

Prerequisites:

- Download the last version of eSetup application from store on your mobile device. The feature « upgrade from Server URL » is available with minimum eSetup version 13.0.0.
- The minimum version of the EVlink Pro AC FW that supports the upgrade from Server is 1.1.6.
- The Connectivity from the Pro AC to Local Area Network (LAN) has been already configured.
- An HTTP server is available and configured on the same LAN than the charging station.
- Download the last Firmware package from [Evlink Pro AC webpage](#) on se.com

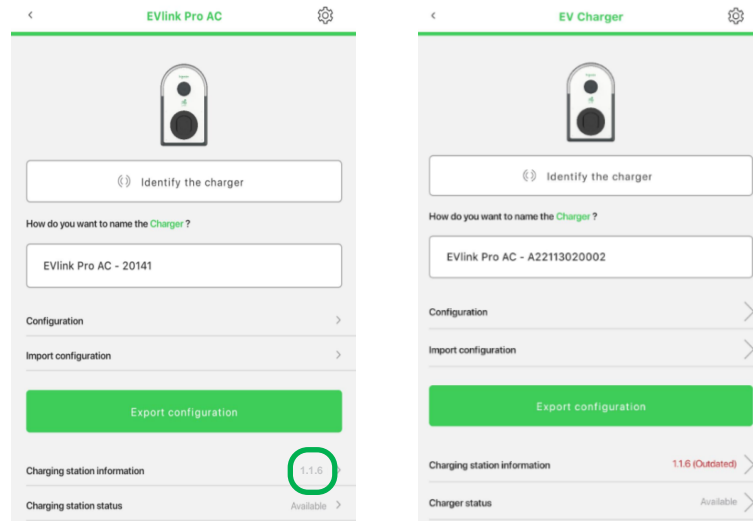

Current version appears : - in grey if « up to date » or if eSetup has never been open with data connection
- in red if a new version has been detected by eSetup on the Schneider Cloud

1st Step : prepare the Server

- Before installing this new FW, it's really important to read the **release note**

You need the package *firmware update from EVCE or OCPP or HTTP SERVER.zip*

(screenshot can be a little bit different) :

- On your laptop, unzip the file

firmware update from EVCE or OCPP or HTTP SERVER.zip

- Copy and paste the FW file (.raucb) at an easy path on the server, rename the file, if necessary (but keep in the name the version, 1.3.0 in this example), you should obtain something like this (screen can be different regarding the server you use) :

EVlink Pro AC Firmware

Référence: GEX28844

EVlink Pro AC_charging station_Release_Note_1-3-6.pdf

↓ 1,1 MB

firmware update from EVCE or OCPP

↓ 69,3 MB

firmware update from eSetup (USB)

↓ 69,3 MB

↓ 1,6 KB

Télécharger ZIP

← ↻ 🏠 ⚠ Non sécurisé | 192.168.0.112/ProAC_FW/

🔍 Google ⚙️ Coupa ⚡ Arc Flash - Services... 🔗 PayLink 🏠 Home 📶 BFO 🔄

Index of /ProAC_FW

Name	Last modified	Size	Description
📁 Parent Directory		-	
📄 ProAC1.3.0.raucb	2023-06-22 15:09	69M	

Apache/2.4.18 (Win32) OpenSSL/1.0.2f PHP/5.6.18 Server at 192.168.0.112 Port 80

2nd Step : FW upgrade (example from version 1.1.6 to 1.3.0)

During the upgrade you will have those screens : just select the mentioned (👉) areas

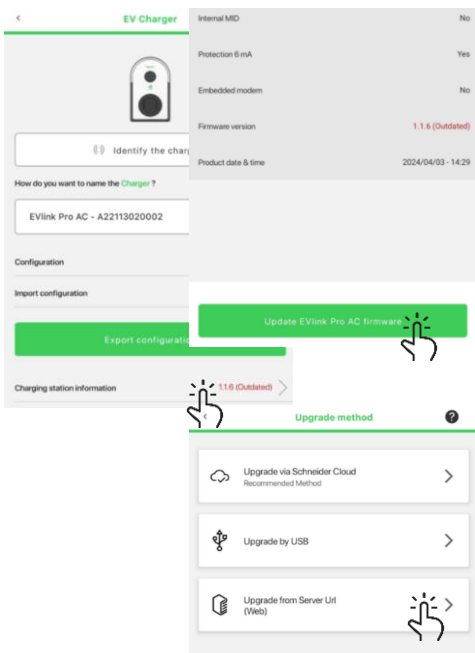

Select “Charging station information” to access to the “update” button



Enter the URL of the FW on the server



Do not switch off the Pro AC during the upgrade and wait the light become green (can take up to 10mn full process)

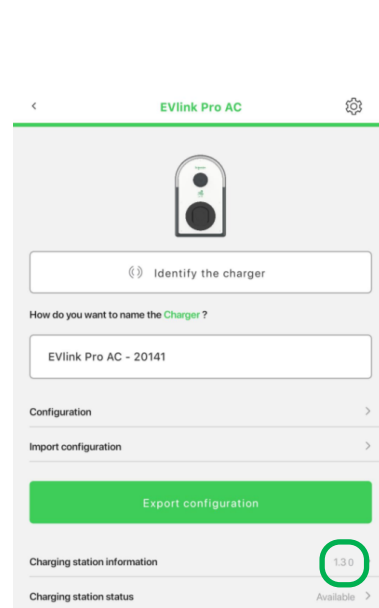

Reconnect eSetup and check the **version**

Life Is On

